

## THOMPSON RETRACTOR LUBRICATION INSTRUCTIONS

In order to keep your Thompson Retractor components working properly, **LUBRICATE ALL MOVING MECHANISMS on instruments with a steam penetrable, water-soluble product after every cleaning cycle, prior to sterilization.**

Examples of areas which may require special attention include the features pictured below. Please refer to individual part laser markings. Automated lubrication application processes may not be effective.

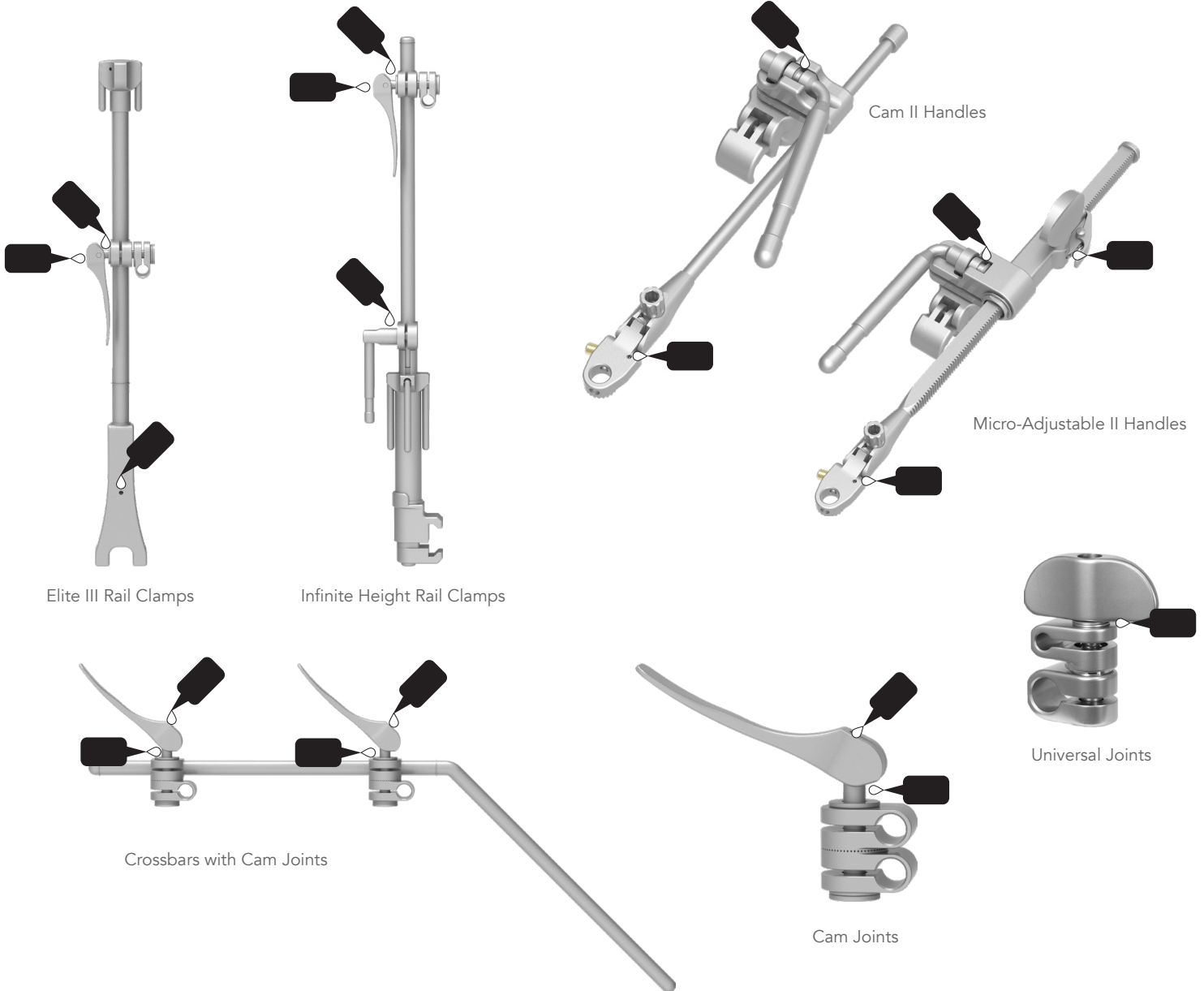

  
10341 East Cherry Bend Road  
Traverse City, Michigan 49684  
phone: 231.922.0177  
fax: 231.922.0174  
[thompsonretractor.com](http://thompsonretractor.com)

For a Free Trial Call **1-800-227-7543** \*

\* Free trial valid for U.S. customers only. Customers outside the U.S.A., please call +1-231-922-0177 for availability.

© 2024 Thompson Surgical Instruments, Inc.

® S-Lock®, PLA®, and the Thompson "T Circle" logomark are Registered Trademarks of Thompson Surgical Instruments, Inc.  
Patents: [tapat.com](http://tapat.com)

EC REP

**Emergo Europe**  
Westervoortsedijk 60  
6827 AT Arnhem  
THE NETHERLANDS

**CE 0297**

Rev F  
120924  
dc lub

**Made In  
USA**