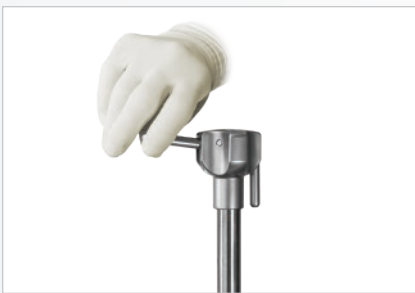

Table Mount for Rack-Based Retractors

The Thompson Table Mount for Rack-Based Retractors provides stable, table-mounted support to compliment self-retaining retractors. The Articulating Arm offers versatile positioning options, accommodating both caudal/cephalad and medial/lateral retraction. (Compatible with most self-retaining racks.)



Stable Table Mount

Elite III Rail Clamp attaches securely to the OR bedrail. Mounts and adjusts within the sterile field.



Fast, Versatile Articulating Arm

Multi-jointed Articulating Arm offers multiplanar positioning to accommodate variable patient anatomy.

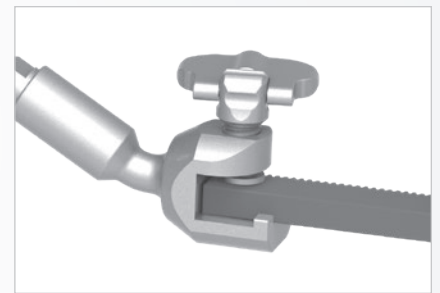

Compatibility

The Articulating Arm Clamp is compatible with most brands of self-retaining racks.

Table Mount for Rack-Based Retractors ORDERING INFORMATION



Table Mount for Rack-Based Retractors #82049

REF	PART #	ITEM DESCRIPTION	QTY
A	43902ACS	Elite III Rail Clamp with 1 Cam Joint 11"	1
B	42170	Clamp Articulating Arm Straight 31"	1
C	50000G	Instrument Case (23" x 11" x 3 1/2")	1



NOTICE:

Articulating Arm Clamp is compatible with most self-retaining racks.



Visit us online: thompsonsurgical.com

For a Free Trial Call **1-800-227-7543** *

* Free trial valid for U.S. customers only. Customers outside the U.S.A., please call +1-231-922-0177 for availability.

© 2022 Thompson Surgical Instruments, Inc.

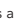
® The "T Circle" logomark  is a Registered Trademark of Thompson Surgical Instruments, Inc.
Patents: tpat.com

Rev A
051623
tmrss

