

S-Lock®  
Quick Angle  
Hand Held  
Adapter

Thompson Retractor 

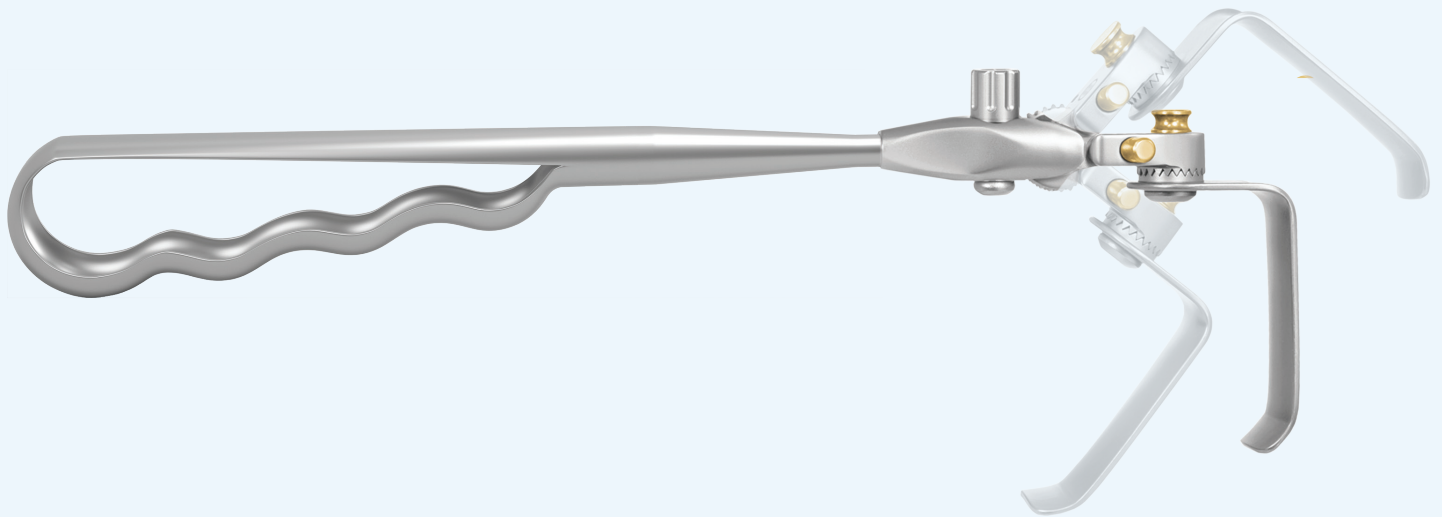

- CONVERT RETRACTOR BLADES TO HAND HELD RETRACTORS
- ALLOWS BLADES TO ANGLE IN OR OUT, AND SWIVEL OR LOCK
- ERGONOMIC GRIP

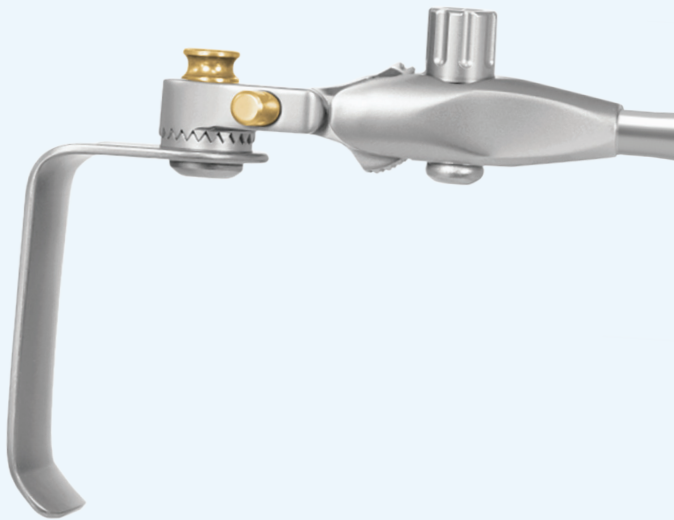

## S-Lock® Hand Held Adapter

The S-Lock Hand Held Adapter quickly and easily allows any Thompson Retractor S-Lock blade to become a hand held retractor. Ideal for when initial exposure requires hand held retractors or when retractors must be hand held for constant repositioning.

1. Simply attach the adapter to the blade nipple by pressing the plunger on the handle and releasing on the 'swivel' groove, or on the 'locked' groove in desired orientation

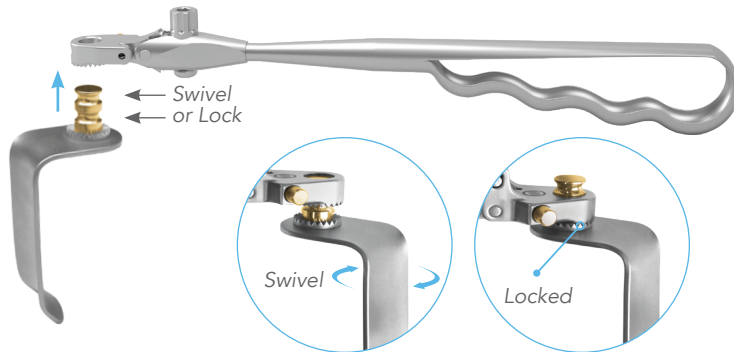

2. Angle if desired

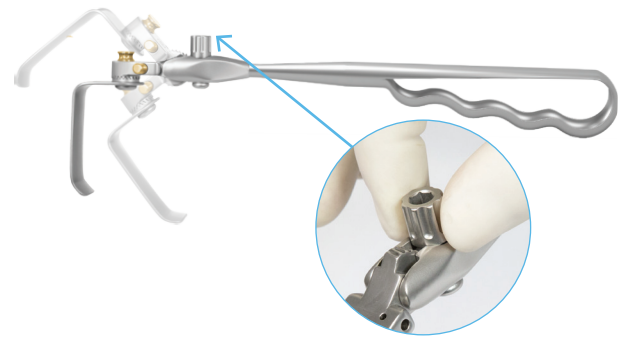

3. Use as needed for hand held retraction

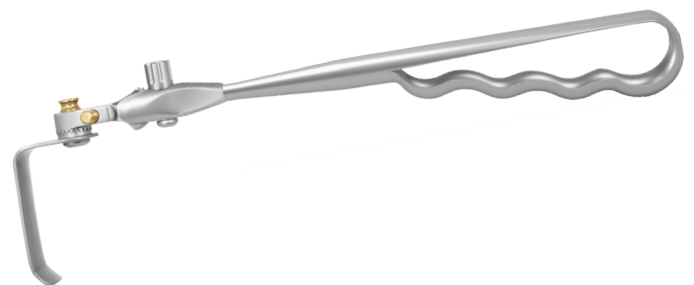

### S-LOCK QUICK ANGLE HAND HELD ADAPTER

S-Lock Quick Angle Hand Held Adapter SL42128G



10341 East Cherry Bend Road  
 Traverse City, Michigan 49684  
 phone: 231.922.0177  
 fax: 231.922.0174

[ThompsonRetractor.com](http://ThompsonRetractor.com)

© 2023 Thompson Surgical Instruments, Inc. Traverse City, Michigan.  
 S-Lock®, PLA®, and the "T Circle" logomark  are Registered Trademarks of Thompson Surgical Instruments, Inc.  
 Patents: US4971038, US5025780, US5888197, US5897087, US5902233, US5984865, US6033363,  
 US6416465, US6511423, US7338442, US7749163, US8257255, US8360971, US8617064.  
 Other patents pending.

Rev C  
 110923  
 hhass0923

Made in the USA

**For a FREE TRIAL  
 call 1.800.227.7543**

Free trial valid for U.S. customers only.  
 International customers please call for more information.