

**Thompson OneFrame® User Manual:**  
SET UP INSTRUCTIONS FOR THOMPSON ONEFRAME®

## OneFrame® Set Up Instructions

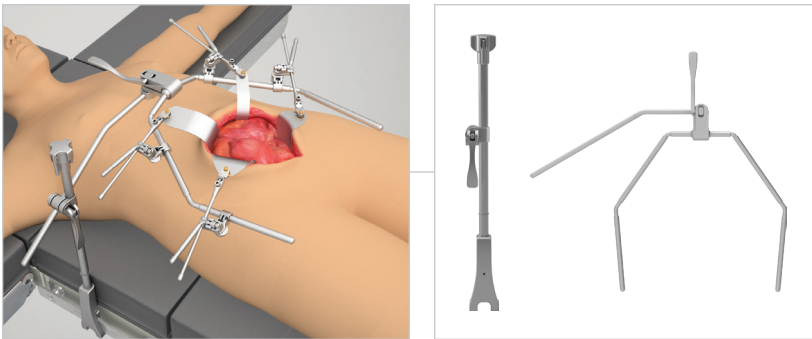

**CAUTION:** Avoid compressing the patient's body with frame components to prevent nerve damage.

**NON STERILE**  
The Thompson Retractor is provided in a non-sterile condition. Refer to Thompson Retractor IFU for cleaning, sterilization, and care instructions.

Reference the Thompson Retractor IFU for additional warnings and cautions.

For other Thompson Retractor Systems, reference corresponding User Manual for each.

### STEP 1: RAIL CLAMP

Place Elite Rail Clamp onto the rail over the sterile drape and turn top knob clockwise to tighten.

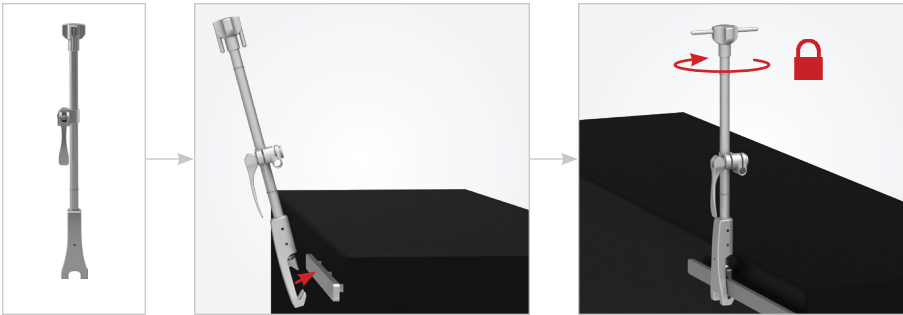

### STEP 2: ATTACH ONEFRAME TO ELITE RAIL CLAMP

Insert OneFrame support arm into joint on the Elite Rail Clamp, position as desired, and flip cam joint handle to secure in place.

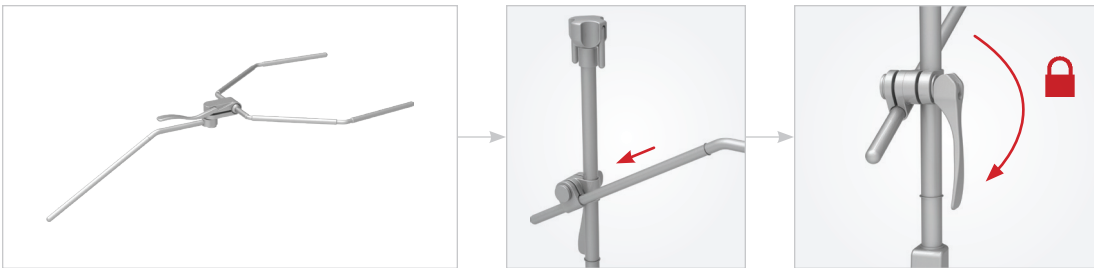

### STEP 3: ONEFRAME ARMS

With the OneFrame joint in the unlocked position, adjust frame arms as desired. Lock into place by flipping joint 180° (pointing away from arms.)

**NOTE:** To avoid damage to the product, DO NOT move frame arms with the frame joint in the locked position.

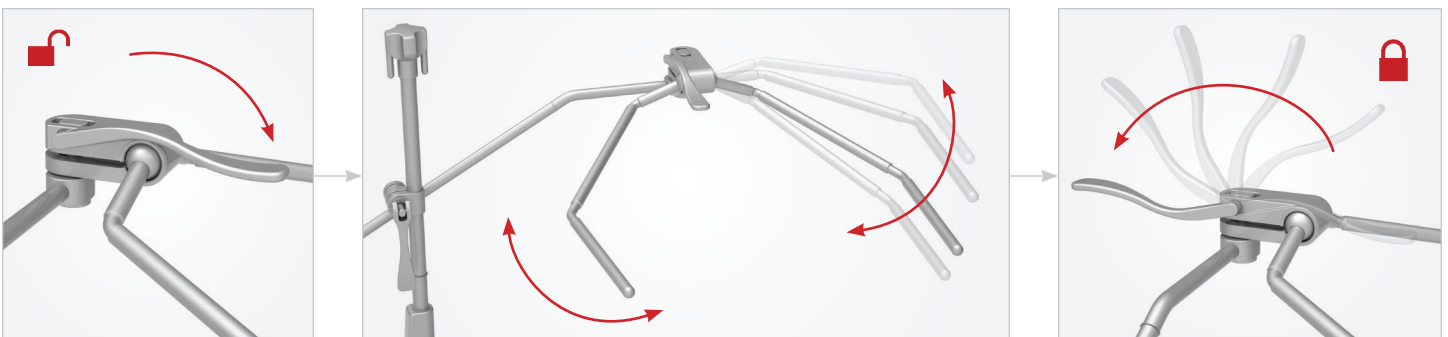

## OneFrame® Set Up Instructions ( Continued )

### OPTIONAL STEP: EXTENSION ARM

If additional inferior retraction is needed, an extension arm may be added. With the extension arm spring hinge in the open position, insert one end of OneFrame arm into spring hinge. With extension arm in position, allow hinge to spring closed and turn knob clockwise to tighten.

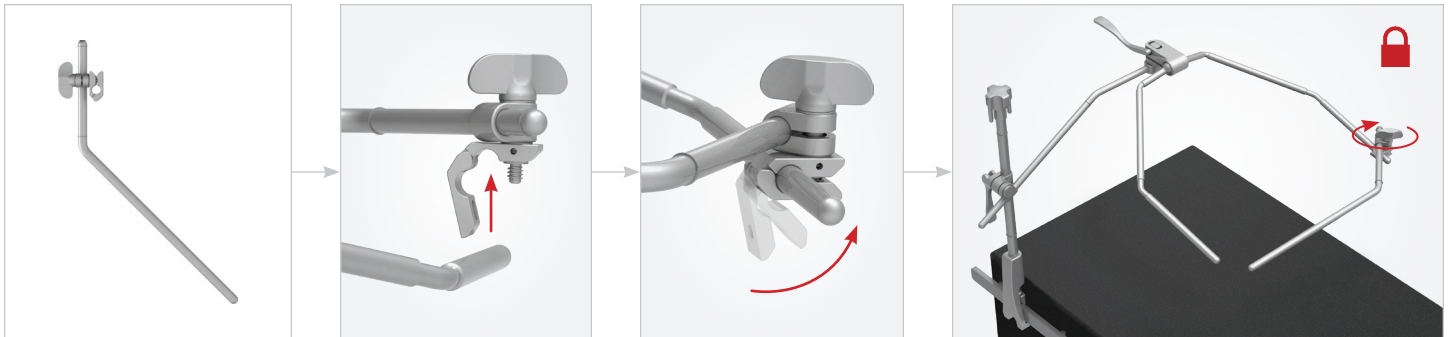

## Handles + Blades

### CLIP-ON HANDLE ATTACHMENT

With joint in unlocked position, clip to frame in desired location, position blade in the incision, and flip the cam joint handle to lock in place.

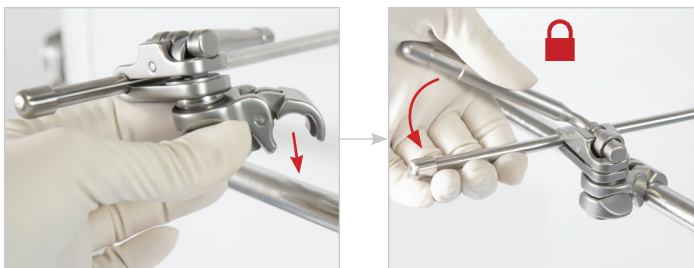

### CLIP-ON HANDLE REMOVAL

Flip cam joint handle to unlocked position, pinch back of cam joint with thumb and index finger, and gently lift up off of arm.

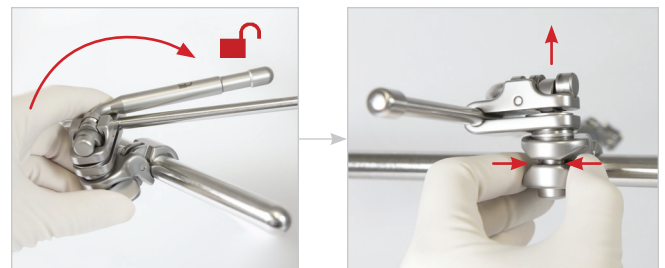

### S-LOCK® HANDLES + BLADES

Attach blade to handle by pushing plunger and inserting blade nipple. Push plunger to release blade and switch between 'swivel' and 'locked' positions.

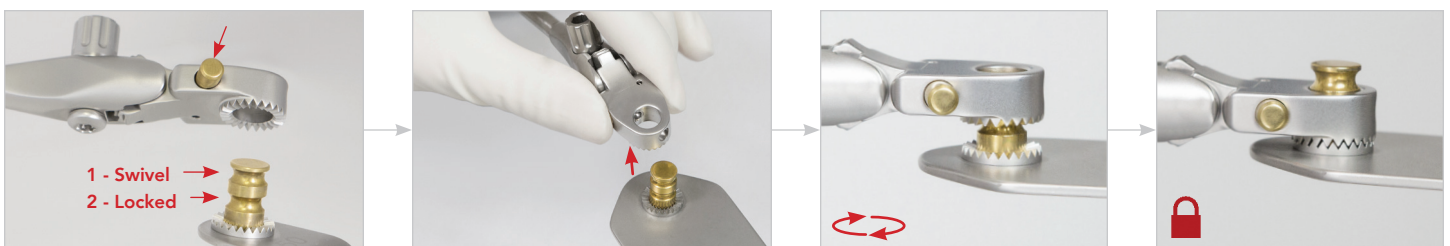

### QUICK ANGLE HANDLES

Blades may be angled 45° up or down by hand or with T-Handle.

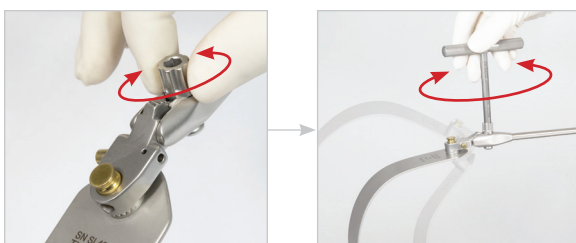

### MICRO-ADJUSTABLE HANDLES

Retract blades further by turning the Micro-Adjustable Handle knob clockwise. Release tension by pressing the pawl.

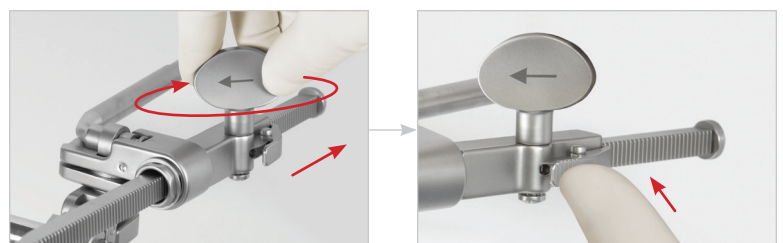

For a Free Trial Call Today\*

**1.800.227.7543**

Rev D  
042324  
dc tofum



Uncompromised Exposure

VISIT US ONLINE: [THOMPSONRETRACTOR.COM](http://THOMPSONRETRACTOR.COM)

 **Thompson**  
SURGICAL INSTRUMENTS  
10341 East Cherry Bend Road  
Traverse City, Michigan 49684  
phone: 231.922.0177  
fax: 231.922.0174  
[thompsonretractor.com](http://thompsonretractor.com)

EC REP **Emergo Europe**  
Westervoortsedijk 60  
6827 AT Arnhem  
THE NETHERLANDS

\* Free trial valid for U.S. customers only. Customers outside U.S. please call +1-231-922-0177 for availability.

© 2024 Thompson Surgical Instruments, Inc. Printed in the U.S.A.

® S-Lock® and the "T Circle" logomark are Registered Trademarks of Thompson Surgical Instruments, Inc.  
Patents: [trpat.com](http://trpat.com)

Note: As we continually strive to provide the best products possible, some of the images in this document may appear slightly different from the product received.

CE 0297

Made In  
USA