

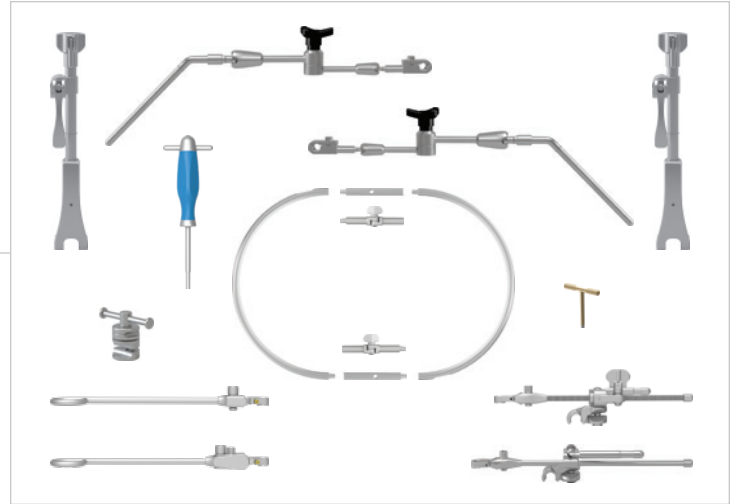

Thompson Anterior Lumbar Ring System User Manual:
SET UP INSTRUCTIONS FOR THOMPSON ANTERIOR LUMBAR RING SYSTEM

Anterior Lumbar Ring Frame User Manual

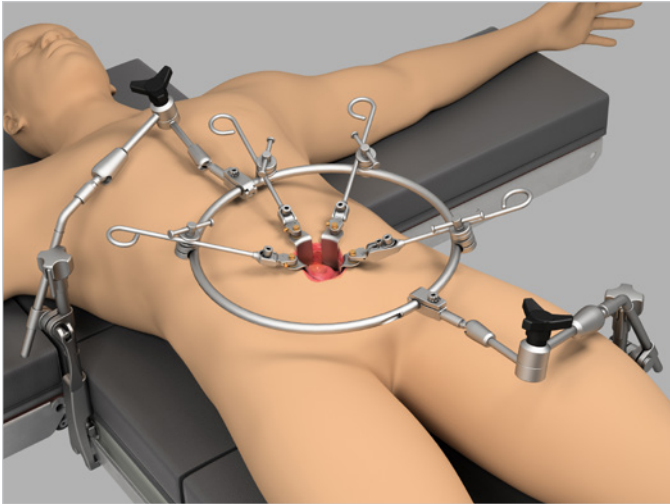

Warnings and Precautions:

-  **CAUTION:** Avoid compressing the patient's body with frame components to prevent nerve damage.
-  Thompson Surgical retractor systems and accessories are supplied non-sterile. Refer to Thompson Retractor IFU for cleaning, sterilization, and care instructions.

Reference the Thompson Retractor IFU for additional warnings and cautions.

For other Thompson Retractor Systems, reference corresponding User Manual for each.

Symbol Legend:

 Manufacturer	 Authorized EC Rep	 CE Mark	 Warnings / Precautions	 Non-Sterile
---	--	--	---	--

Ring Frame Set Up

IF USING A JACKSON SPINE TABLE: JACKSON FRAME ADAPTER

Place Jackson Frame Adapter onto table and turn knob clockwise to tighten. Once secured, a Thompson rail clamp may be added.

NOTE: Jackson Frame Adapter is for attachment of Thompson Retractors only. DO NOT use with other retractors as it may not be compatible.

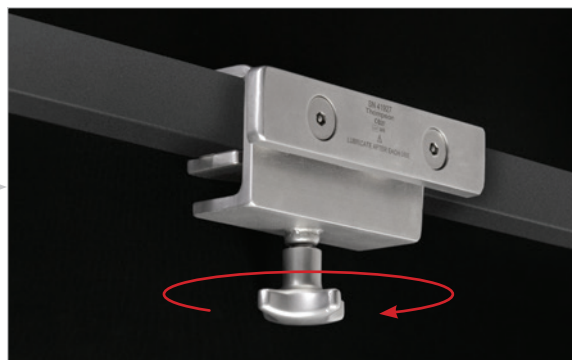

Ring Frame Set Up (Continued)

STEP 1: RAIL CLAMPS

Place Elite Rail Clamp onto the rail over the sterile drape near the axilla of the patient, adjacent to armboard, and turn top knob clockwise to tighten. Repeat on opposite side of table, near the upper thigh, 10 - 12" below midpoint of incision.

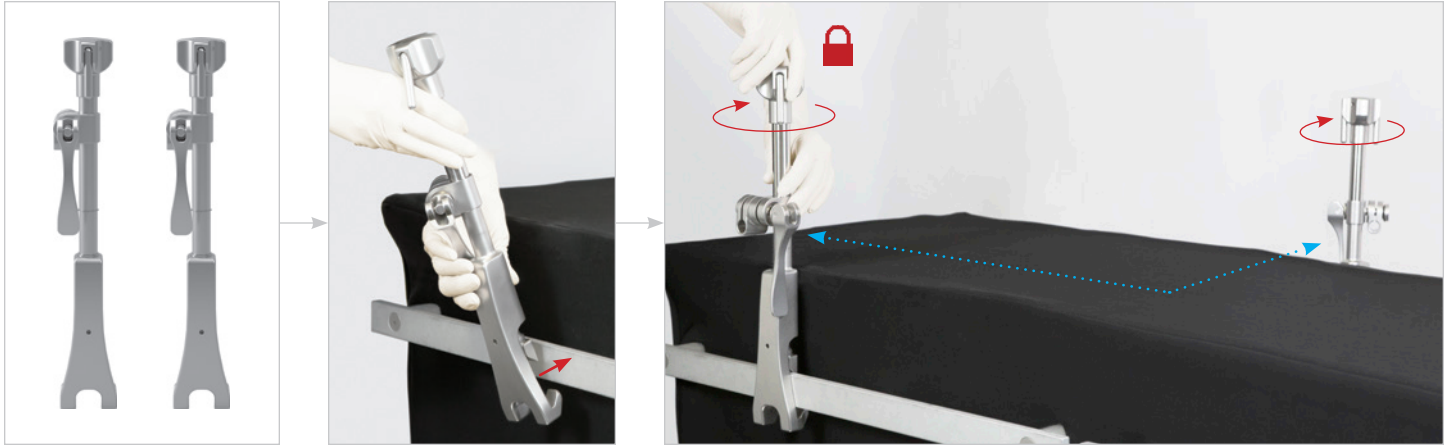

STEP 2: ADD EXTENSION ARMS

Insert the extension arm into the joint on the Elite Rail Clamp, position, and flip the cam joint handle to lock. Repeat on opposite side. Once in place, adjust the extension arm by turning the black knob counter-clockwise to loosen and clockwise to tighten.

TIP: For easier attachment, tighten the black knob before this step, keeping the adjustable portion of arm in place.

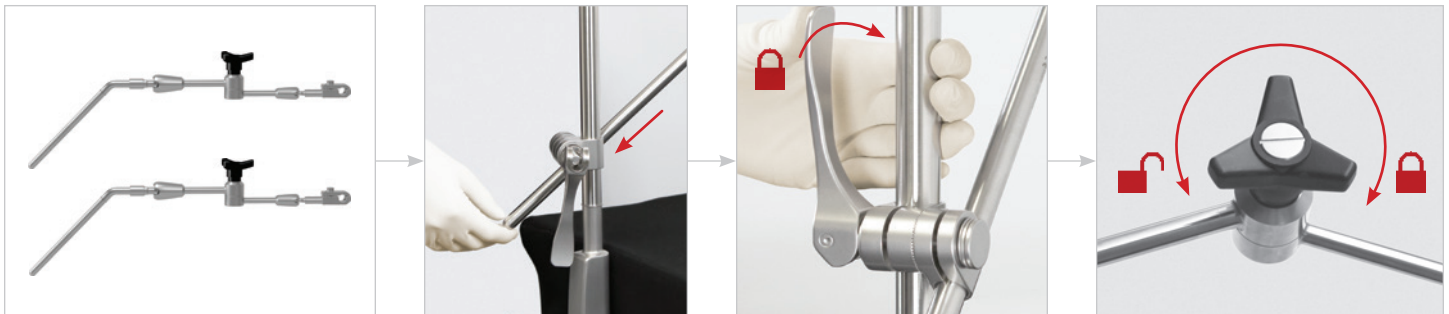

STEP 3: CIRCLE RING ASSEMBLY

Connect ring halves and secure by tightening screw on each side using the hex tool.

Ensure both sides of ring frame are seated properly prior to tightening screw.

TIP: Ring can be pre-assembled at beginning of case or during frame set up.

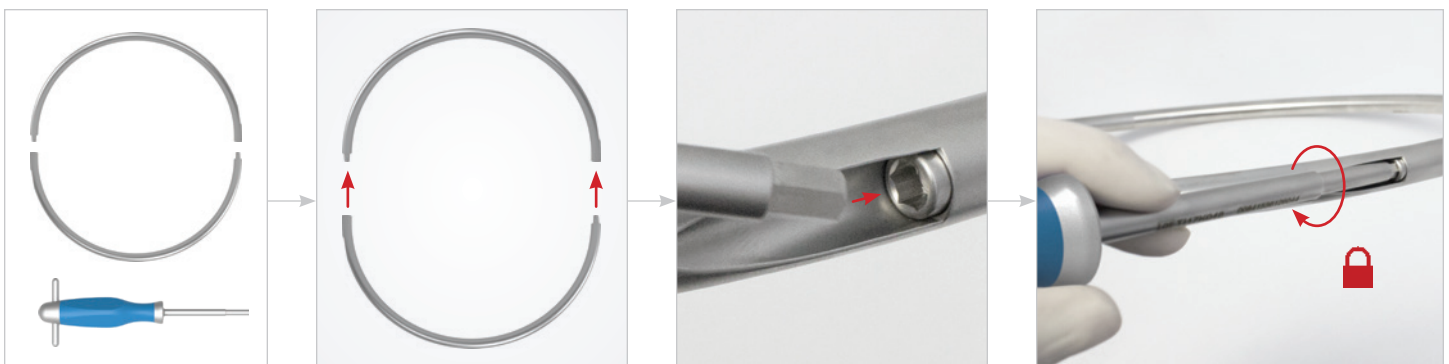

NOTE: BEFORE SEPARATING RING HALVES, BE SURE THAT BOTH SCREWS ARE FULLY DISENGAGED FROM OPPOSITE RING HALF. SCREW SHOULD NOT BE FORCED IN OR OUT OF RING.

Ring Frame Set Up (Continued)

OVAL RING ASSEMBLY (OPTIONAL)

Connect ring extensions to ring halves by inserting male end of ring into female end of ring extension, and turning ring extension clockwise to tighten. Repeat with second ring half and ring extension. Connect ring halves and secure by tightening screw on each side using the hex tool.

TIP: Ring can be pre-assembled at beginning of case or during frame set up.

DISASSEMBLY TIP: Hex tool may be inserted into exterior hole of ring extension to aid in counter-clockwise rotation when loosening, if needed.

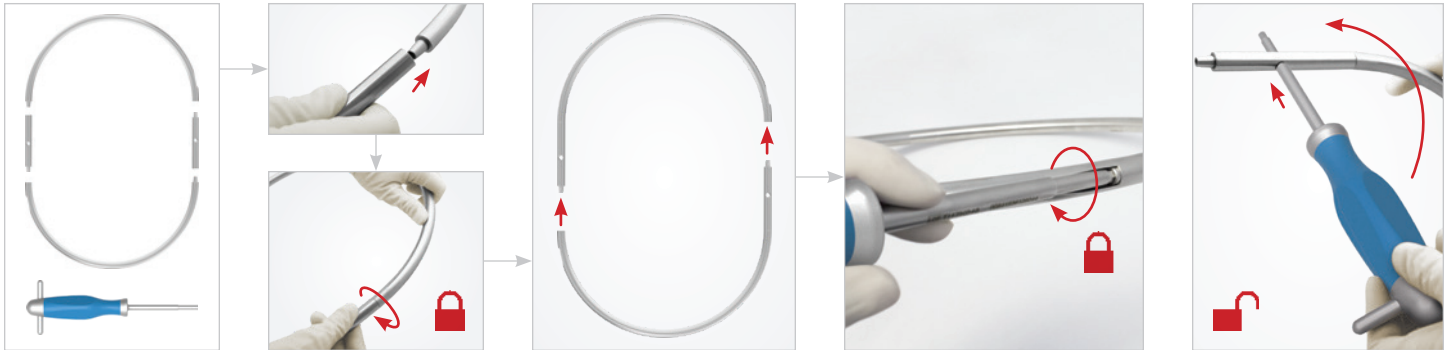

NOTE: BEFORE SEPARATING RING HALVES, BE SURE THAT BOTH SCREWS ARE FULLY DISENGAGED FROM OPPOSITE RING HALF. SCREW SHOULD NOT BE FORCED IN OR OUT OF RING.

HINGED RING ASSEMBLY (OPTIONAL)

Connect hinged ring extensions to ring halves by inserting male end of ring into female end of hinged ring extension, and turning hinged ring extension clockwise to tighten. Repeat with second ring half and hinged ring extension. Connect ring halves, ensuring the hinged extension knobs are pointing to the outsides of ring, and secure by tightening screw on each side using the hex tool.

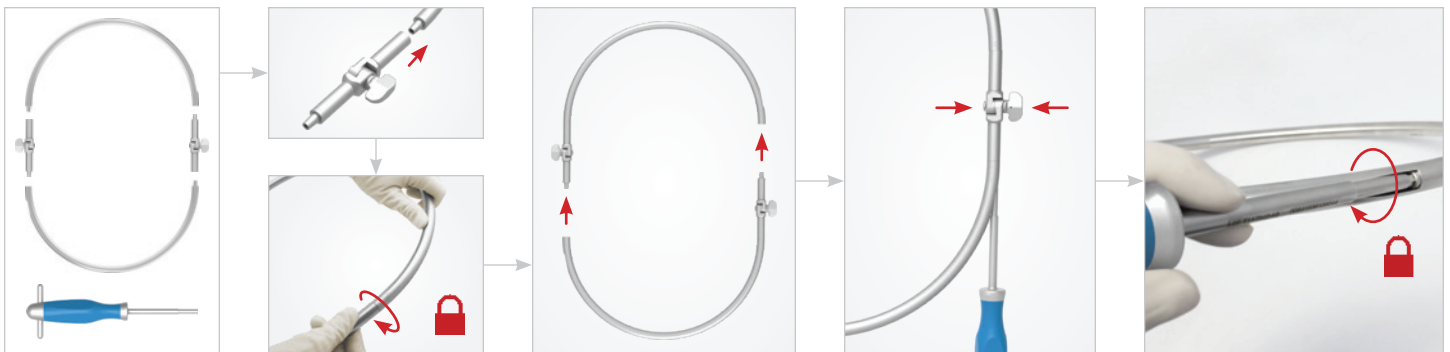

ADJUSTING HINGED RING

Turn knobs on the hinged ring extensions counter-clockwise to loosen. Adjust ring halves to desired position and turn hinged ring extension knobs clockwise to tighten, ensuring serrations are securely mated.

TIP: Ring can be pre-assembled at beginning of case or during frame set up.

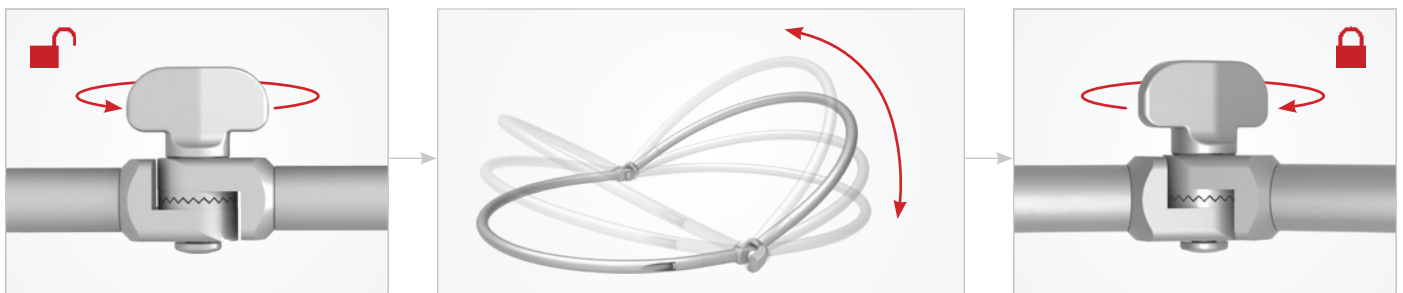

NOTE: BEFORE SEPARATING RING HALVES, BE SURE THAT BOTH SCREWS ARE FULLY DISENGAGED FROM OPPOSITE RING HALF. SCREW SHOULD NOT BE FORCED IN OR OUT OF RING.

Ring Frame Set Up (Continued)

STEP 4: ATTACH RING

Place ring in hinge joint on first Articulating Arm. Use hex tool to tighten. Repeat with second Articulating Arm. Ring should be 2 - 3" above patient.

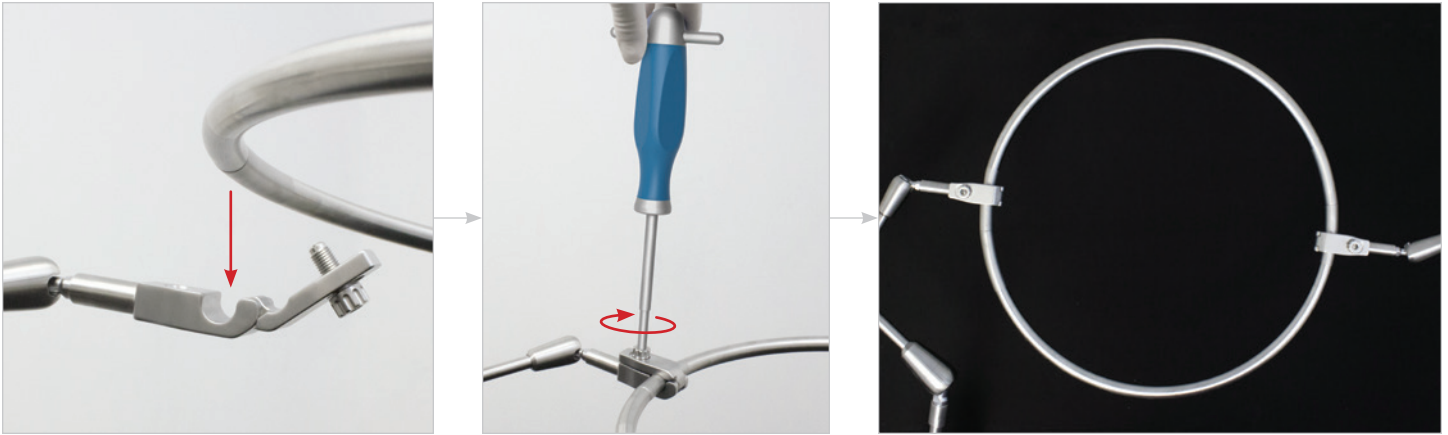

STEP 5: CLIP-ON JOINT ATTACHMENT

Fully unlock circle joints by turning the sliding T-Handle counter-clockwise. Clip circle joints on to ring in desired locations.

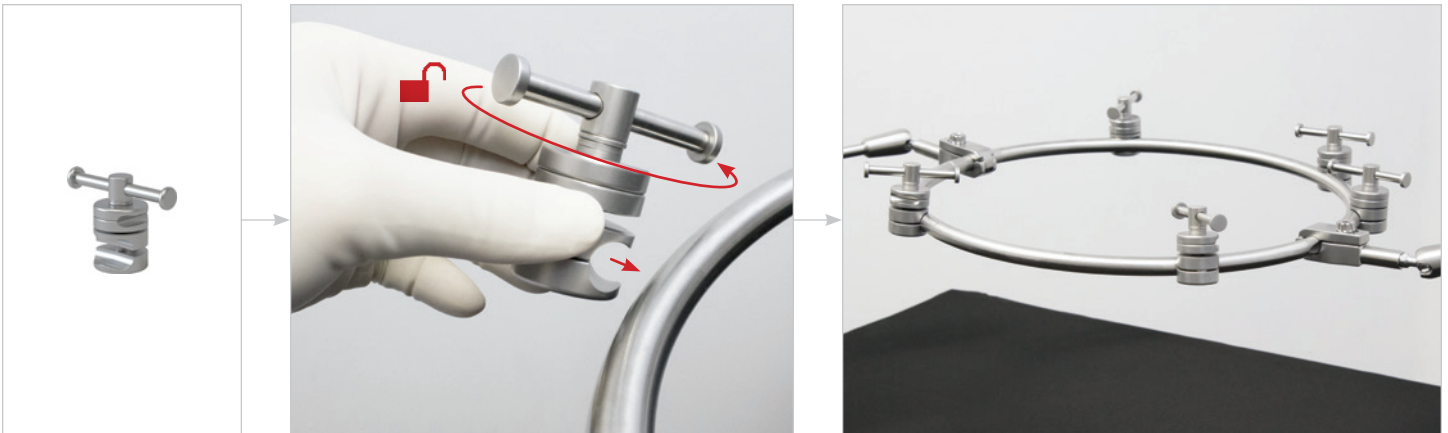

STEP 6: ATTACH HANDLES TO JOINTS

Attach handles by clipping into the side of the circle joint. Secure handle in place by turning the sliding T-handle clockwise.



Handles + Blades

S-LOCK® HANDLES + BLADES

Attach blade to handle by pushing plunger and inserting blade nipple. Push plunger to release blade and switch between 'swivel' and 'locked' positions.

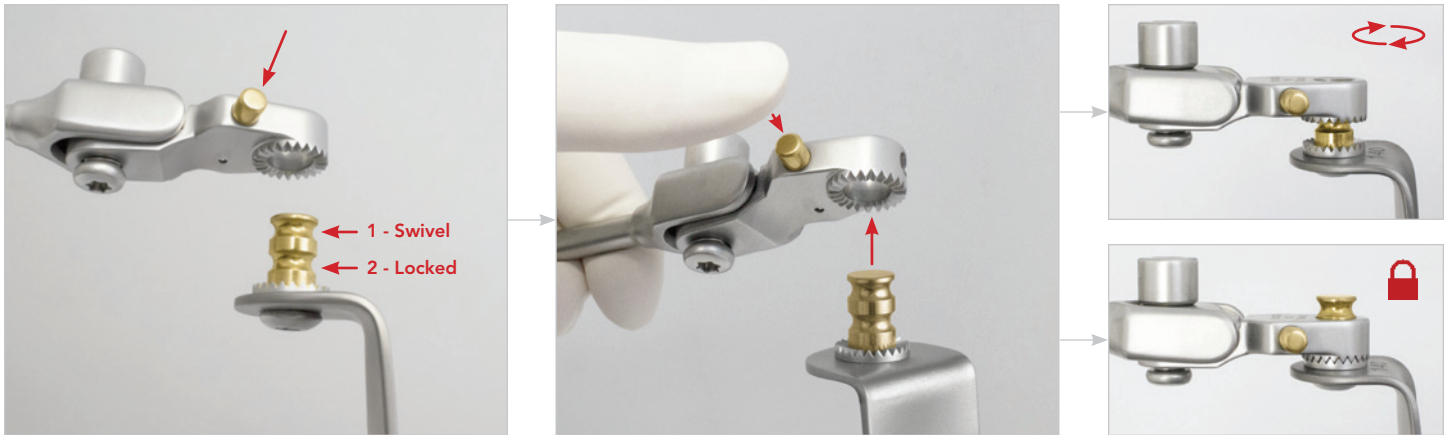

FREE ANGLE HANDLES

Blades may be angled freely by placing the hex tool in the free angle mechanism and positioning blade in desired location. Tighten the mechanism to secure blade in place by turning the hex tool clockwise. This may be done before or after handle is secured to the frame.

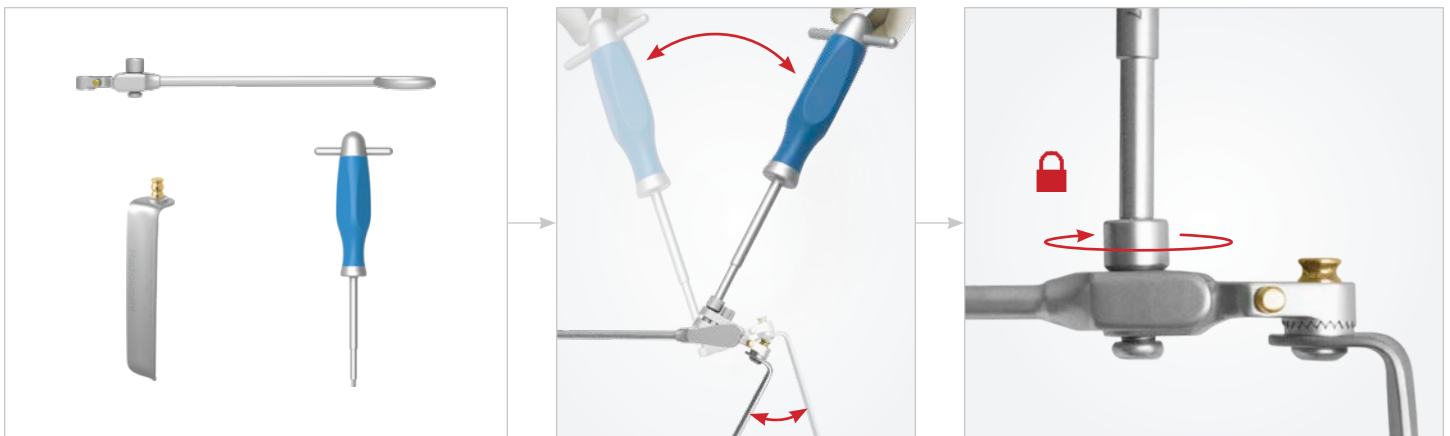

DUAL ANGLE HANDLES

After positioning and tightening blade using the Free Angle mechanism as described in the previous step, additional precise angling may be achieved by using the hex tool to rotate the ribbed Quick Angle mechanism (QA) up or down.

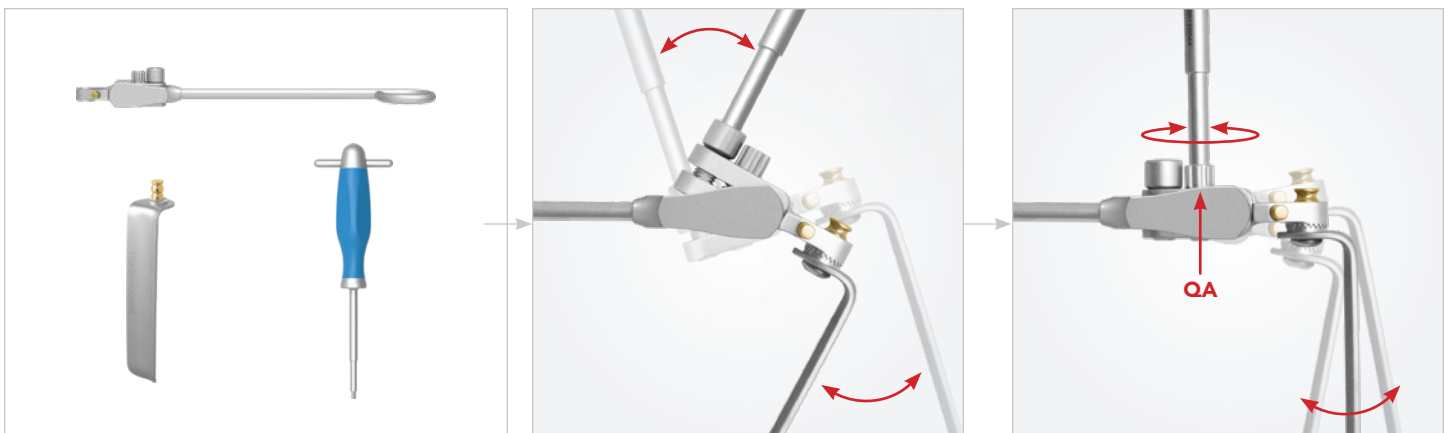

Handles + Blades

CLIP-ON HANDLE ATTACHMENT

With joint in unlocked position, clip to frame in desired location, position blade in the incision, and flip the cam joint handle to lock in place.

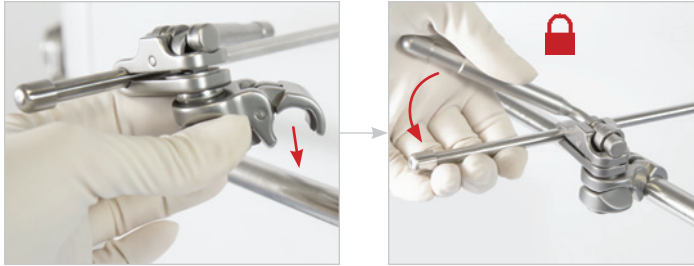

CLIP-ON HANDLE REMOVAL

Flip cam joint handle to unlocked position, pinch back of cam joint with thumb and index finger, and gently lift up off of arm.

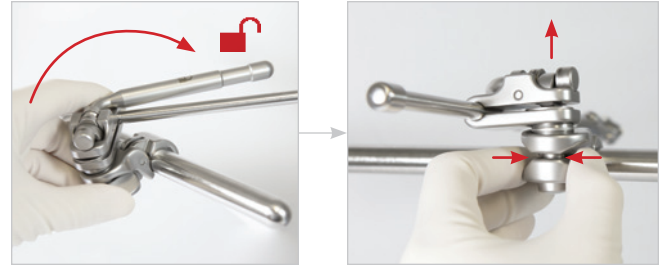

QUICK ANGLE HANDLES

Blades may be angled 45° up or down by hand or with T-Handle.



MINI MICRO-ADJUSTABLE HANDLE

Retract blades further by turning the Micro-Adjustable Handle knob clockwise. Release tension by pressing the pawl. The Mini Micro-Adjustable knob may be folded down to create an even lower profile.

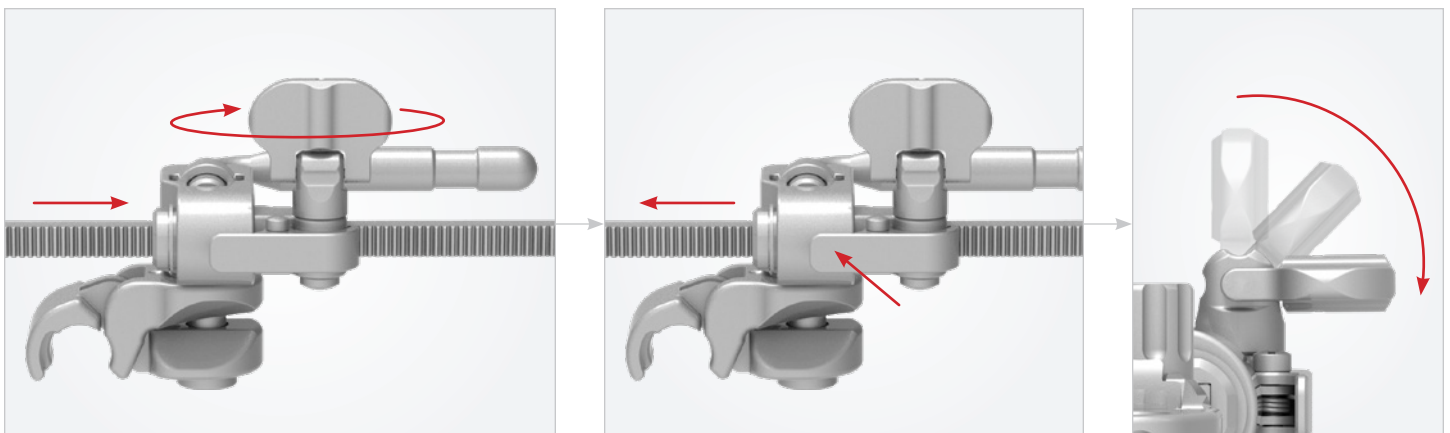

For a Free Trial Call Today*

1.800.227.7543

Rev H
011123
dc alrum



Uncompromised Exposure

VISIT US ONLINE: THOMPSONSURGICAL.COM



Thompson
SURGICAL INSTRUMENTS

10341 East Cherry Bend Road
Traverse City, Michigan 49684

phone: 231.922.0177

fax: 231.922.0174

thompsonsurgical.com

EC REP

Emergo Europe

Westervoortsedijk 60

6827 AT Arnhem

THE NETHERLANDS

* Free trial valid for U.S. customers only. Customers outside U.S. please call +1-231-922-0177 for availability.

© 2021 Thompson Surgical Instruments, Inc. Printed in the U.S.A.

® S-Lock®, PLA®, and the "T Circle" logomark are Registered Trademarks of Thompson Surgical Instruments, Inc.

Patents: trpat.com

Note: As we continually strive to provide the best products possible, some of the images in this document may appear slightly different from the product received.

CE 0297

Made In
USA